



BLATCH
FINE HOMES

Tel: +44 (0) 24 7624 9333

info@blatchfinehomes.co.uk



42 Knoll Drive
Coventry, CV3 5BU

£800,000



6



3



2



C

42 Knoll Drive



Description

This impressive six-bedroom family home offers a rare opportunity to purchase a substantially extended property. The house stands out immediately, offering generous internal space, modern finishes and exceptional outdoor living.

- Six well-proportioned bedrooms offering excellent space throughout
- Two spacious reception rooms providing flexible living and entertaining areas
- Separate spacious dining room ideal for family meals and hosting guests
- Newly renovated bathrooms finished to a modern, high-quality standard
- Self-contained annex with its own bathroom and kitchen, ideal for guests, extended family or independent living
- Substantially extended family home, rare for this popular Coventry road
- Stunning kitchen with large central island and abundant natural light
- Practical utility room keeping everyday living neatly organised
- Generous rear garden featuring a swimming pool and ample outdoor entertaining space
- EPC Rating C





Floor Plan

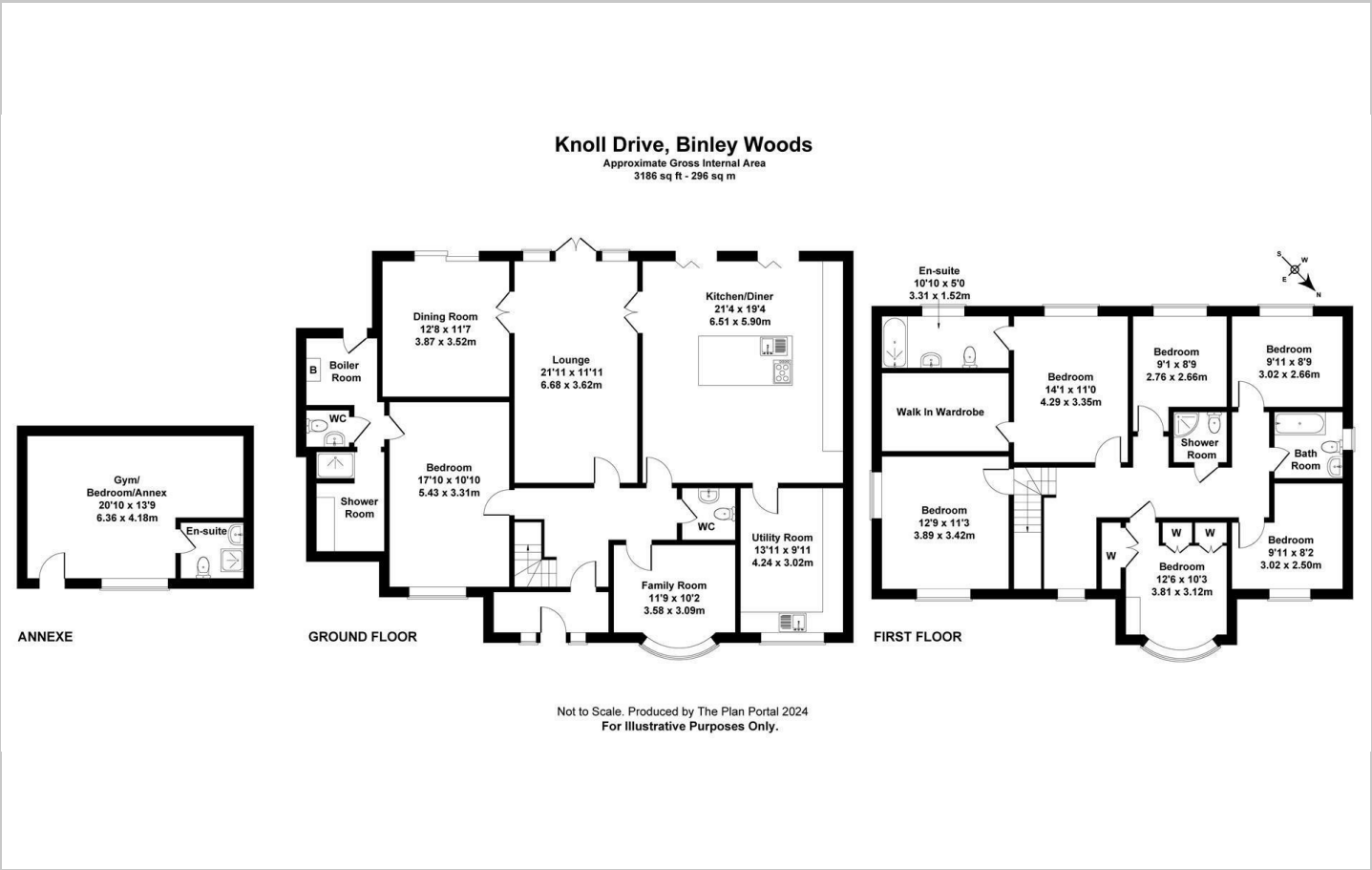

Area Map

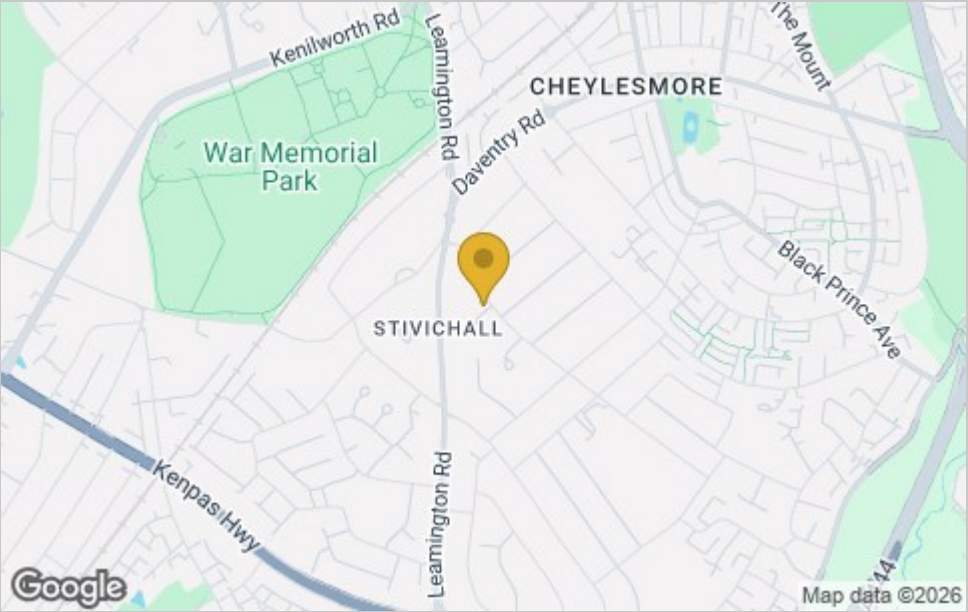

Viewing

Please contact our Coventry Office on 02476249333 if you wish to arrange a viewing appointment for this property or require further information.

These particulars, whilst believed to be accurate are set out as a general outline only for guidance and do not constitute any part of an offer or contract. Intending purchasers should not rely on them as statements of representation of fact, but must satisfy themselves by inspection or otherwise as to their accuracy. No person in this firms employment has the authority to make or give any representation or warranty in respect of the property.

Energy Efficiency Graph

